

# Gate Installation Illustrations

## Please Note:

When installing a Gate Post, orientation of the steel insert is critical. It may be necessary to remove the insert and position it correctly for your application. The steel inserts are in the shape of a  with 2 legs connected by a solid back. The solid back of the steel insert needs to be oriented inside the post sleeve facing the inside of the fenced area. The gate is designed to "swing inside". Hinge Bolts must be located 1" from the solid back of the steel insert and drilled through both legs as illustrated here to the right [www.woodshadesfencing.com](http://www.woodshadesfencing.com)

| Hanging Gate Post with steel | 3-hole, Lowe's # | no hole, Lowe's # |
|------------------------------|------------------|-------------------|
| Redwood                      | 190298           | 345799            |
| Cedar                        | 189917           | 345797            |
| Barnwood                     | 189921           | 345800            |
| Black Gate Frame             | 345798           |                   |

## Left-Swing, In-line Installation

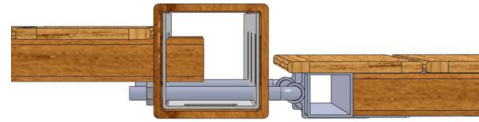

Gate swings open toward interior area of fencing

## Right-Swing, In-line Installation

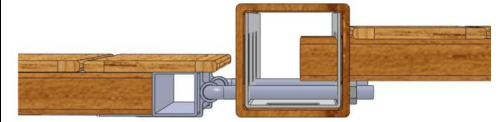

Gate swings open toward interior area of fencing

## Left-Swing, Perpendicular Installation



Gate swings open toward interior area of fencing

## Right-Swing, Perpendicular Installation

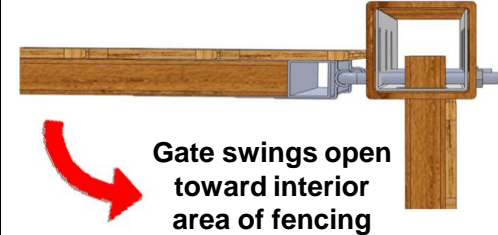

Gate swings open toward interior area of fencing

## Left-Swing, Lone Soldier Installation

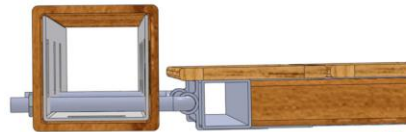

Gate swings open toward interior area of fencing

## Right-Swing, Lone Soldier Installation

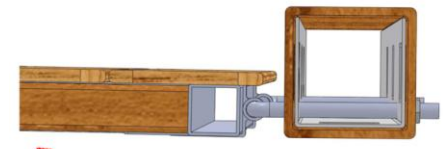

Gate swings open toward interior area of fencing